

All costs and expense associated with removal or reinstallation or transportation of the PermaClad exterior wall panels for purposes of performing warranty work or replacement thereof under this limited warranty shall be at the customer's sole cost and expense and shall not be included as part of this limited warranty.

This limited warranty shall be performed at Innovative Concrete Products' usual place of business and all PermaClad exterior wall panels shall be shipped to Innovative Concrete Products and returned to the customer, both ways F.O.B. Innovative Concrete Products Plant, Spokane, Washington, USA.

### 8. MAINTENANCE

Most applications require no maintenance. Exterior application where excessive dust or dirt are prevalent should be washed down occasionally. Soiled areas should be cleaned with detergent and water, using a fiber brush and sponge, and rinsed thoroughly with clean water.

### 9. TECHNICAL SERVICES

Technical personnel are available for consultation with architects, engineers, fabricators, installers and owners to discuss type selection, costs, fabrication and installation procedures.

**Specification Writers:** Please obtain a copy of Innovative Concrete Products' ManuSpec for PermaClad panels and use it as a basis for your specifications. It may be obtained from a local PermaClad representative or from Innovative Concrete Products' Customer Service in Spokane, Washington.

### 10. FILING SYSTEMS

- CSI's SPEC-SEARCH™
- IHS' SPEC DATA® II

Additional product information available upon request. Contact a local PermaClad representative or call Innovative Concrete Products' Customer Service

## PREFABRICATED PANEL: CROSS SECTION

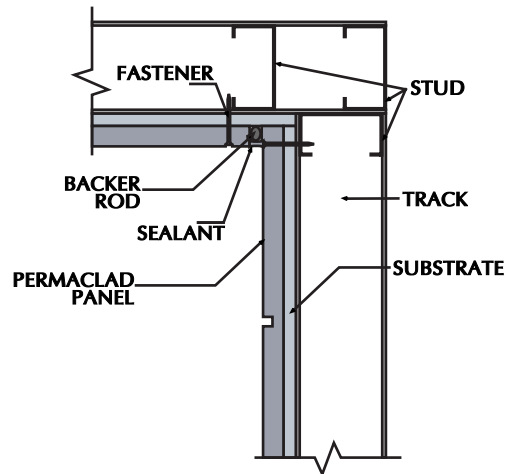

INSIDE CORNER PANEL ASSEMBLY

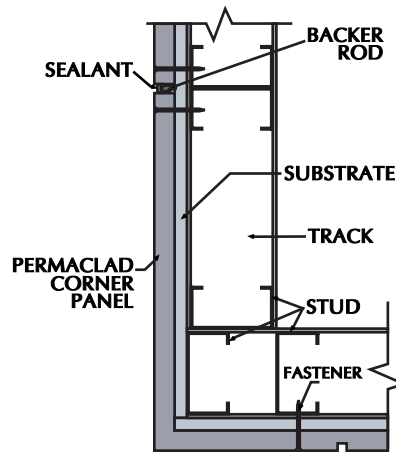

OUTSIDE CORNER PANEL ASSEMBLY

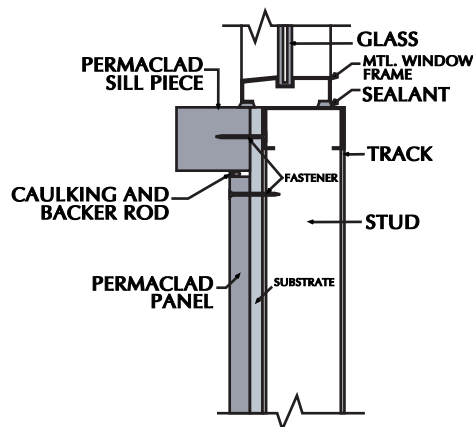

SILL OF PANEL ASSEMBLY